

Green Pin® Standard Bow Shackles G-4161

with screw collar pin

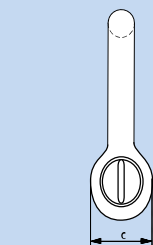

Material: Body and pin high tensile steel, Grade 6, quenched and tempered
Safety Factor: MBL equals 6 x WLL
Standard: EN 13889 and meets performance requirements of US Fed Spec RR-C-271, Type IVA Class 2, Grade A
Finish: Hot dipped galvanised
Temp Range: Minus 20°C up to 200°C
Certificate: As standard an EC declaration of conformity is supplied, also upon request a basic raw material cert, manufacturer test cert, inspection cert and DNV cert (2t above)

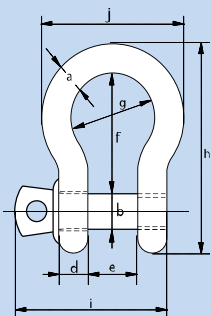

working load limit	bow dia	pin dia	eye dia	width eye	width inside	length inside	width bow	length	length bolt	width bow	product code	weight each
tons	a mm	b mm	c mm	d mm	e mm	f mm	g mm	h mm	i mm	j mm		kg
0.33	5	6	12	5	9.5	22	16	36	29.5	26	SGSBS06	0.02
0.5	7	8	16.5	7	12	29	20	48.5	38	34	SGSBS08	0.05
0.75	9	10	20	9	13.5	32	22	56	46.5	40	SGSBS10	0.10
1	10	11	22.5	10	17	36.5	26	63.5	54	46	SGSBS11	0.14
1.5	11	13	26.5	11	19	43	29	74	59.5	51	SGSBS13	0.19
2	13.5	16	34	13	22	51	32	89	73	58	SGSBS16	0.36
3.25	16	19	40	16	27	64	43	110	89	75	SGSBS19	0.63
4.75	19	22	46	19	31	76	51	129	103	89	SGSBS22	1.01
6.5	22	25	52	22	36	83	58	144	119	102	SGSBS25	1.50
8.5	25	28	59	25	43	95	68	164	137	118	SGSBS28	2.21
9.5	28	32	66	28	47	108	75	185	153	131	SGSBS32	3.16
12	32	35	72	32	51	115	83	201	170	147	SGSBS35	4.31
13.5	35	38	80	35	57	133	92	227	186	162	SGSBS38	5.55
17	38	42	88	38	60	146	99	249	203	175	SGSBS42	7.43
25	45	50	103	45	74	178	126	300	243	216	SGSBS50	12.84
35	50	57	111	50	83	197	138	331	272	28	SGSBS57	18.15
42.5	57	65	130	57	95	222	160	377	310	274	SGSBS65	26.29
55	65	70	145	65	105	260	185	433	344	310	SGSBS70	37.60

Green Pin® Standard Bow Shackles G-4163

with safety bolt

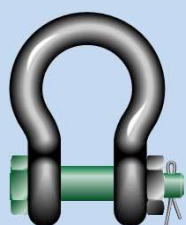

Material: Body and pin high tensile steel, Grade 6, quenched and tempered
Safety Factor: MBL equals 6 x WLL
Standard: EN 13889 and meets performance requirements of US Fed Spec RR-C-271, Type IVA Class 3, Grade A
Finish: Hot dipped galvanised
Temp Range: Minus 20°C up to 200°C
Certificate: As above

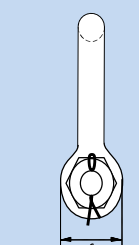
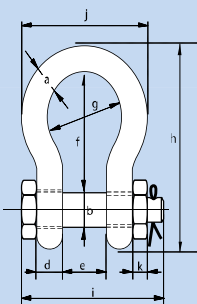

working load limit	bow dia	pin dia	eye dia	width eye	width inside	length inside	width bow	length	length bolt	width bow	width	product code	weight each
tons	a mm	b mm	c mm	d mm	e mm	f mm	g mm	h mm	i mm	j mm	k mm		kg
0.5	7	8	16.5	7	12	29	20	48.5	42	34	4	SGSBB08	0.06
0.75	9	10	20	9	13.5	32	22	56	50	40	5	SGSBB10	0.11
1	10	11	22.5	10	17	36.5	26	63.5	60	46	8	SGSBB11	0.16
1.5	11	13	26.5	11	19	43	29	74	67	51	11	SGSBB13	0.22
2	13.5	16	34	13.5	22	51	32	89	82	58	13	SGSBB16	0.42
3.25	16	19	40	16	27	64	43	110	98	75	17	SGSBB19	0.74
4.75	19	22	46	19	31	76	51	129	114	89	19	SGSBB22	1.18
6.5	22	25	52	22	36	83	58	144	130	102	22	SGSBB25	1.77
8.5	25	28	59	25	43	95	68	164	150	118	25	SGSBB28	2.58
9.5	28	32	66	28	47	108	75	185	166	131	27	SGSBB32	3.66
12	32	35	72	32	51	115	83	201	178	147	30	SGSBB35	4.91
13.5	35	38	80	35	57	133	92	227	197	162	33	SGSBB38	6.54
17	38	42	88	38	60	146	99	249	202	175	19	SGSBB42	8.19
25	45	50	103	45	74	178	126	300	249	216	23	SGSBB50	14.22
35	50	57	111	50	83	197	138	331	269	238	26	SGSBB57	19.85
42.5	57	65	130	57	95	222	160	377	301	274	29	SGSBB65	28.33
55	65	70	145	65	105	260	180	433	330	310	32	SGSBB70	39.59
85	75	83	162	73	127	329	190	527	380	340	39	SGSBB83	62.00