

Green Pin® Standard Dee Shackles G-4151

with screw collar pin

Material: Body and pin high tensile steel, Grade 6, quenched and tempered
Safety Factor: MBL equals 6 x WLL
Standard: EN 13889 and meets performance requirements of US Fed Spec RR-C-271, Type IVB Class 2, Grade A
Finish: Hot dipped galvanised
Temp Range: Minus 20°C up to 200°C
Certificate: As standard an EC declaration of conformity is supplied, also upon request a basic raw material cert, manufacturer test cert, inspection cert and DNV cert (2t above)

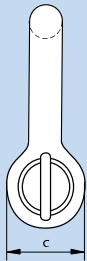
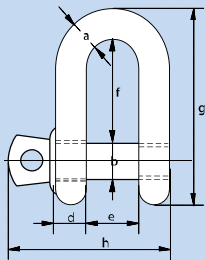
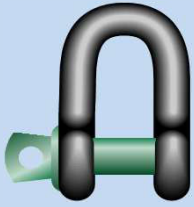

working load limit	bow dia	pin dia	eye dia	width eye	width inside	length inside	length	length bolt	product code	weight each
tons	a mm	b mm	c mm	d mm	e mm	f mm	g mm	h mm		kg
0.33	5	6	12	5	9.5	19	33	29.5	SGSDS06	0.02
0.5	7	8	16.5	7	12	22	41.5	38	SGSDS08	0.05
0.75	9	10	20	9	13.5	26	50	46.5	SGSDS10	0.09
1	10	11	22.5	10	17	32	59	54	SGSDS11	0.14
1.5	11	13	26.5	11	19	37	68	59.5	SGSDS13	0.19
2	13.5	16	34	13	22	43	81	73	SGSDS16	0.32
3.25	16	19	40	16	27	51	97	89	SGSDS19	0.54
4.75	19	22	46	19	31	59	112	103	SGSDS22	0.87
6.5	22	25	52	22	36	73	134	119	SGSDS25	1.34
8.5	25	28	59	25	43	85	154	137	SGSDS28	2.08
9.5	28	32	66	28	47	90	167	153	SGSDS32	2.77
12	32	35	72	32	51	94	180	170	SGSDS35	3.72
13.5	35	38	80	35	57	115	209	186	SGSDS38	5.14
17	38	42	88	38	60	127	230	203	SGSDS42	6.85
25	45	50	103	45	74	149	271	243	SGSDS50	11.45
35	50	57	111	50	83	171	305	272	SGSDS57	16.86
42.5	57	65	130	57	95	190	345	310	SGSDS65	24.61
55	65	70	145	65	105	203	376	344	SGSDS70	32.65

Green Pin® Standard Dee Shackles G-4153

with safety bolt

Material: Body and pin high tensile steel, Grade 6, quenched and tempered
Safety Factor: MBL equals 6 x WLL
Standard: EN 13889 and meets performance requirements of US Fed Spec RR-C-271, Type IVB Class 3, Grade A
Finish: Hot dipped galvanised
Temp Range: Minus 20°C up to 200°C
Certificate: As above

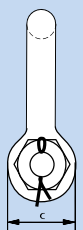
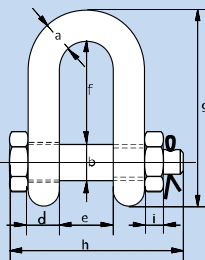
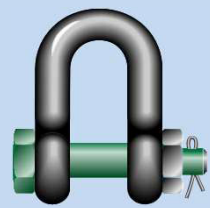

working load limit	bow dia	pin dia	eye dia	width eye	width inside	length inside	length	length bolt	width nut	product code	weight each
tons	a mm	b mm	c mm	d mm	e mm	f mm	g mm	h mm	i mm		kg
2	13.5	16	34	13	22	43	81	82	13	SGSDB16	0.39
3.25	16	19	40	16	27	51	97	98	17	SGSDB19	0.67
4.75	19	22	46	19	31	59	112	114	19	SGSDB22	1.08
6.5	22	25	52	22	36	73	134	130	22	SGSDB25	1.66
8.5	25	28	59	25	43	85	154	150	25	SGSDB28	2.46
9.5	28	32	66	28	47	90	167	166	27	SGSDB32	3.40
12	32	35	72	32	51	94	180	178	30	SGSDB35	4.51
13.5	35	38	80	35	57	115	209	197	33	SGSDB38	6.10
17	38	42	88	38	60	127	230	202	19	SGSDB42	7.63
25	45	50	103	45	74	149	271	249	23	SGSDB50	13.25
35	50	57	111	50	83	171	305	269	26	SGSDB57	18.53
42.5	57	65	130	57	95	190	345	301	29	SGSDB65	25.94
55	65	70	145	65	105	203	376	330	32	SGSDB70	35.33
85	75	83	162	73	127	229	427	380	39	SGSDB83	52.97