

Large Bow Shackles

with type A screw collar pin

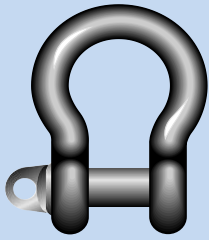

Material: Body and pin high tensile steel
Safety Factor: MBL equals 5 x WLL
Standard: B.S.3032 table 3 - 1958
Finish: Self colour
Certificate: As standard an EC declaration of conformity is supplied, also upon request a certificate of basic raw material
Notes: Hot dipped galvanised also available

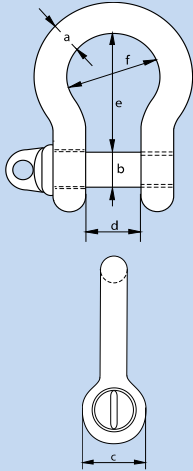

working load limit	diameter bow	diameter pin	diameter eye	inside width	inside length	width bow	product code	weight each
tons	a inch	b inch	c inch	d inch	e inch	f inch		kg
0.15	1/4	3/8	3/4	1/2	1.1/8	3/4	SHLBS10	0.08
0.45	3/8	1/2	1	5/8	1.5/8	1	SHLBS13	0.18
0.75	1/2	5/8	1.1/4	7/8	2.1/8	1.1/4	SHLBS16	0.34
1.25	5/8	3/4	1.1/2	1.1/8	2.3/4	1.5/8	SHLBS19	0.65
2.00	3/4	7/8	1.3/4	1.3/8	3.3/8	2	SHLBS22	1.08
2.75	7/8	1	2	1.5/8	3.7/8	2.1/4	SHLBS25	1.80
3.75	1	1.1/8	2.1/4	1.3/4	4.1/4	2.1/2	SHLBS29	2.46
4.75	1.1/8	1.1/4	2.1/2	2	4.7/8	2.7/8	SHLBS32	3.47
5.75	1.1/4	1.3/8	2.3/4	2.1/4	5.3/8	3.1/4	SHLBS35	4.56
7.25	1.3/8	1.1/2	3	2.1/2	6	3.1/2	SHLBS38	6.07
8.50	1.1/2	1.3/4	3.1/2	2.3/4	6.5/8	3.7/8	SHLBS44	8.35
9.50	1.5/8	1.7/8	3.3/4	3	7.3/8	4.3/8	SHLBS48	11.81
11.50	1.3/4	2	4	3.3/8	8.1/8	4.3/4	SHLBS51	14.32
13.00	1.7/8	2.1/8	4.1/4	3.5/8	8.3/7	5.1/8	SHLBS54	17.03
15.00	2	2.1/4	4.1/2	3.7/8	9.3/8	5.1/2	SHLBS57	20.00

Large Bow Shackles

with type E bolt and nut pin

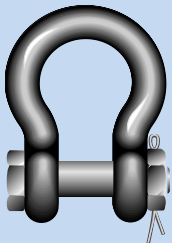

Material: Body and pin high tensile steel
Safety Factor: MBL equals 5 x WLL
Standard: B.S.3032 table 3 - 1958
Finish: Self colour
Certificate: As standard an EC declaration of conformity is supplied, upon request a certificate of basic raw material
Notes: Hot dipped galvanised also available

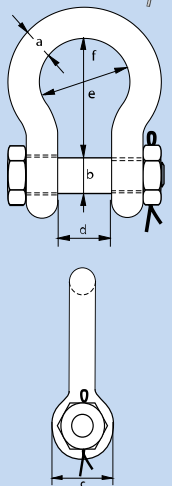

working load limit	diameter bow	diameter pin	diameter eye	inside width	inside length	width bow	product code	weight each
tons	a inch	b inch	c inch	d inch	e inch	f inch		kg
0.15	1/4	3/8	3/4	1/2	1.1/8	3/4	SHLBB10	0.09
0.45	3/8	1/2	1	5/8	1.5/8	1	SHLBB13	0.21
0.75	1/2	5/8	1.1/4	7/8	2.1/8	1.1/4	SHLBB16	0.40
1.25	5/8	3/4	1.1/2	1.1/8	2.3/4	1.5/8	SHLBB19	0.70
2.00	3/4	7/8	1.3/4	1.3/8	3.3/8	2	SHLBB22	1.25
2.75	7/8	1	2	1.5/8	3.7/8	2.1/4	SHLBB25	2.00
3.75	1	1.1/8	2.1/4	1.3/4	4.1/4	2.1/2	SHLBB29	2.85
4.75	1.1/8	1.1/4	2.1/2	2	4.7/8	2.7/8	SHLBB32	3.94
5.75	1.1/4	1.3/8	2.3/4	2.1/4	5.3/8	3.1/4	SHLBB35	4.95
7.25	1.3/8	1.1/2	3	2.1/2	6	3.1/2	SHLBB38	7.00
8.50	1.1/2	1.3/4	3.1/2	2.3/4	6.5/8	3.7/8	SHLBB44	9.45
9.50	1.5/8	1.7/8	3.3/4	3	7.3/8	4.3/8	SHLBB48	12.67
11.50	1.3/4	2	4	3.3/8	8.1/8	4.3/4	SHLBB51	15.85
13.00	1.7/8	2.1/2	4.1/4	3.5/8	8.3/4	5.1/8	SHLBB54	18.80
15.00	2	2.1/4	4.1/2	3.7/8	9.3/8	5.1/2	SHLBB57	21.56